



Swift Clipper™

Button-Operated Cat Claw Clipper

Swift by Design. Safe by Nature. Care with Confidence.

User Manual & Quick Guide

Swift Clipper™

Swift Clipper is the world's first button-operated mechanical claw clipper designed specifically for cats and small pets. Introduced in 2025, this innovative grooming tool features a safe enclosed body and a replaceable hardened carbon steel blade — delivering clean, precise, and pain-free cuts without damaging the claw structure.

What's Included

- Swift Clipper (1)
- Nosepieces: 2 mm and 3 mm
- Hardened carbon steel blades (6): 1 installed + 5 stored in the Built-in Spare Blade Slot

Product Dimensions

Length: 103.5 mm (4.1 in)
Height (with button): 60 mm (2.4 in)
Thickness: 42 mm (1.7 in)
Weight: 60 g (2.1 oz)

First-time Use. Try Before You Clip

To get familiar with the Swift Clipper's motion, try clipping a soft object first — like a wooden toothpick or matchstick.

This will help you understand how the blade moves and how much force is needed, so you feel confident before using it on your cat.

Choosing the Right Claw Opening

Swift Clipper includes three interchangeable nosepieces with different claw insertion openings:
2 mm (0.08 in), 3 mm (0.12 in), and 4 mm (0.16 in) in diameter.

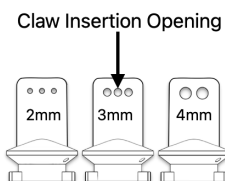

Each size offers a different level of clipping depth and control. Choose based on your pet's claw size and trimming needs.

• 2 mm (0.08 in) Opening – Small

Recommended for trimming only the sharp tip of the claw (about 2–3 mm).

Ideal for kittens, small pets, or claws with a fine, narrow profile.

• 3 mm (0.12 in) Opening – Medium

Suitable for adult cats and most regular grooming.

Allows for moderate trimming (up to ~5 mm) while maintaining safety and control.

• 4 mm (0.16 in) Opening – Large

Designed for trimming of overgrown claws.

Allows deeper insertion and cutting, but requires greater caution and visual control to avoid clipping into the quick.

Recommended for confident users and professional

How Much to Clip?

- The goal is to trim only the sharp tip of the claw — just enough to reduce scratching, not to shorten the entire claw.
- If you're unsure, trim less — just a tiny sliver of the tip.
- Most cat claws are translucent — you may see the pink quick inside.
- The quick is the living part of the claw, containing blood vessels and nerves. Cutting it can cause pain and bleeding.
- Always check the claw in good light.
- **Insert the claw into the nosepiece only until the quick is clearly visible outside the front opening — with at least 1–2 mm (0.04–0.08 in) of space above it.**
- This ensures that the clip line remains safely 4 mm (0.16 in) away from the quick, helping prevent accidental cuts.

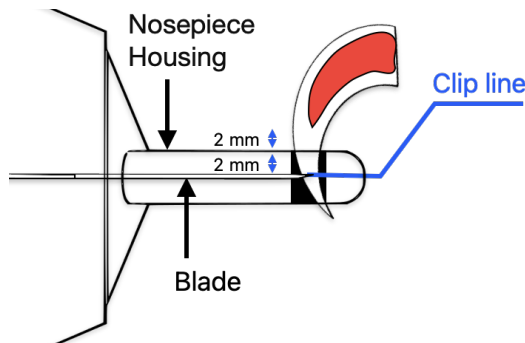
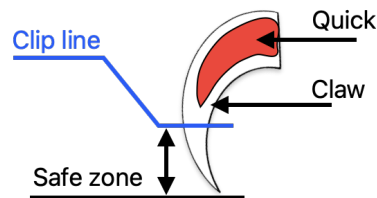

- The internal blade sits 2 mm below the top edge of the nosepiece, allowing safe clearance.

Claw Clipping

1. Insert the claw into the selected opening of the nosepiece.
2. Press the button gently — the mechanism will smoothly trim the excess claw length.
3. Release the button — the blade will return to its original position.

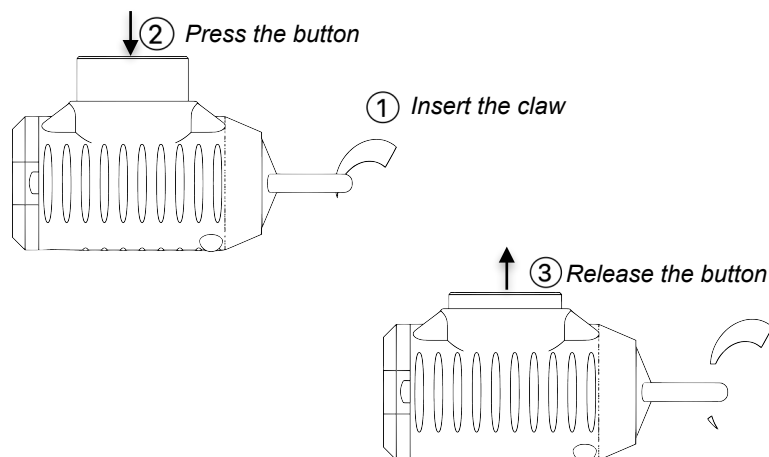

Replacing the Blade or Nosepiece

To replace the blade or nosepiece, follow the illustrations below.

Assembled View

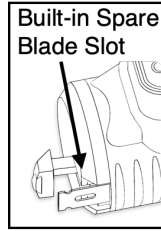
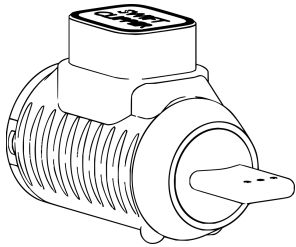

Rotate and Remove the Nosepiece
Turn the nosepiece 90° counterclockwise and pull it off.

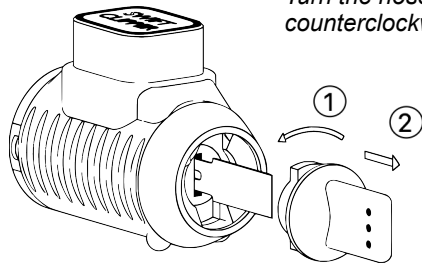

Replace the Blade
Pull out the used blade and insert a new one vertically into the blade slot.

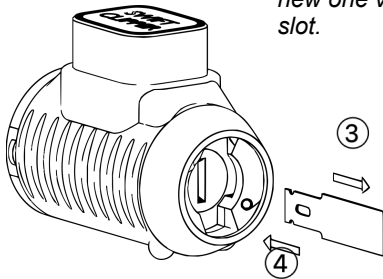

Reattach and Lock the Nosepiece
Place the nosepiece back and rotate 90° clockwise until it clicks into place. No extra force is needed — the click indicates it is fully installed and secure.

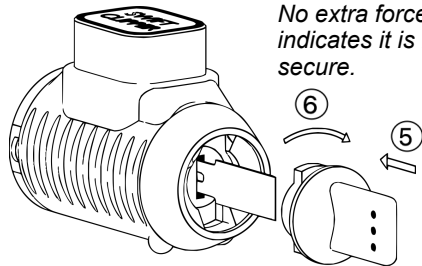

Returns & Refunds

We accept returns within 30 days of delivery for unused products in original condition and packaging. Due to hygiene and safety reasons, used items cannot be returned, except in the case of a verified manufacturing defect. If your product arrives damaged or becomes defective under normal use, please contact us. For return or warranty inquiries, contact: support@swiftclipper.com

Safety

- The blade is extremely sharp. Handle with care.
- Never touch the cutting edge directly with your fingers.
- Always keep out of reach of children.
- Do not allow children to operate this device.
- Check the device before each use to ensure the blade is properly installed and the nosepiece is locked in place.
- Store in a dry place.

Care & Maintenance

Wipe the clipper body and button with a soft cloth using mild soap solution or 70% isopropyl alcohol.

Do not immerse the clipper in water or expose internal parts to moisture.

Do not use acetone, kerosene, acids, or other harsh chemicals — these may damage the housing and mechanism.

The nosepiece can be removed and washed separately by immersion in soap solution or disinfectant.

(Suitable for professional hygiene protocols.)

The blade may be wiped or disinfected using isopropyl alcohol or chlorhexidine-based solutions.

Do not wash the blade with water, as this may lead to rust.

For personal home use, blades can be reused many times without issue.

For professional grooming or veterinary use, it is recommended to replace the blade after each animal to maintain hygiene and prevent cross-

Professional Sanitation Recommendation.

For veterinary clinics and grooming professionals

Swift Clipper uses hardened carbon steel blades that are extremely sharp and durable.

However, the factory edges are **not polished** and may contain micro-grooves where contamination can persist.

To maintain strict hygiene standards, we recommend:

Replacing the blade after each animal for quick and effortless sanitation.

Or soaking used blades in disinfectant (e.g., isopropyl alcohol, chlorhexidine, or veterinary-grade solutions) for thorough cleaning and later reuse.

Additionally:

Always use a clean and disinfected nosepiece for each animal.

Materials

Made from plastic, stainless steel, carbon steel, and a neodymium magnet.

Plastic components are safe for contact with human skin and animals.

This product contains a small neodymium magnet. Keep away from pacemakers and other sensitive medical devices.

Limited Warranty

Swift Clipper is covered by a 1-year limited warranty against manufacturing defects in materials and workmanship under normal use. This warranty does not cover normal wear and tear of blades or nosepieces, accidental damage, misuse, or modifications.

For warranty support or service inquiries, please contact: support@swiftclipper.com

Need Help?

Visit swiftclipper.com or contact: support@swiftclipper.com